

OZ HIGH SPEED DOOR STD DATA SHEET

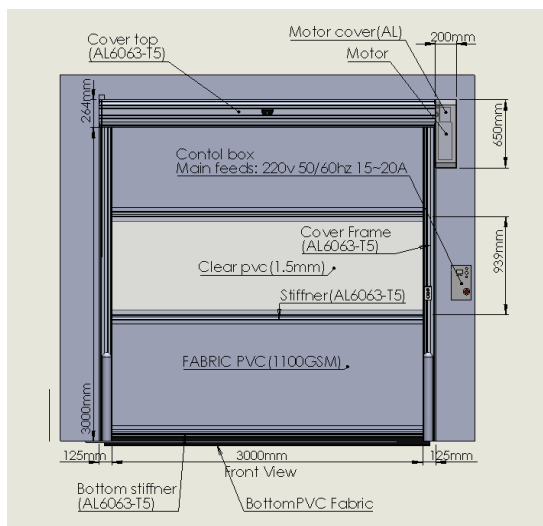

Door type	OZ HSD Standard
Suitable application	Interior/external
Size	
Width(M)	Max 6M
Height(M)	Max 6M
Total door leaf weight	-
Speed with control	
Max. opening(m/s)	700mm~1500mm/s (According to setting)
Closing approx(mm/s)	700~1500mm/s (According to setting)
Temperature range(°C)	-5~+60
Main power(V)	220 V single phase
Power frequency(Hz)	50/60hz
Rate output power(KW)	0.75KW ~1.5KW(Accoding to door size)
IP degree	IP54
Resistance to wind load (EN 12424)	Class 2(Beaufort scale 5)
Thermal insulation(m ² ·K) (EN 13241-1, ISO 12567-1)	
Emergency opening	By Handle

Perfact Warranty

Hardware 2 Years/Motor 2 Years

Servo controll system



Motor

Rated Output Power(KW)	0.75	1.5
Dimension(L*W*H/mm)	440x110x180	522x130x200
Rated Speed(RPM)	2000	2000
Gear ratio	15:1	15:1
Limit Mode		Absolute Encoder
Self Locking Mode		Electro Mechanical Brake
Manual Release		Handle
Weight(net)(Kg)	10.3	17.3

Control box

Enclosure material	SPCC
Dimension(L*W*H)	340x195x95(125)(include E-STOP)
Rate output power(KW)	0.75~2.2
External power supply(VDC/A)	24/0.4
Weight(net)(Kg)	

Feature

PLC Converter,
Soft run/Soft stop,
LCD(EN),
3 Mode(Auto/Manual/Jog),
Torque Auto-adjusting,
Speed setting,

Anti-frozen running,
Interlock(Air-curtain,2 doors, Machine.),
Self-diagnosis,
Statistics Management,
Faults history,
Maintenance Reminder

FRAME

Frame	Aluminum alloy 6063 T5 3m
Cover	Aluminum alloy 6063 T5 1.5m

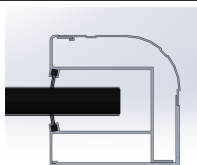

TOP

Back cover	Galvanized Steel 1.5mm
Side-bracket	Galvanized Steel 5mm
Bearing	Asahi Series
Motor bushing	Rubber
Motor bracket	Galvanized Steel 5mm
Cover-Drum	Aluminum alloy 6063 T5 1.5m
Roll-pipe	SS400 with Coated insulation

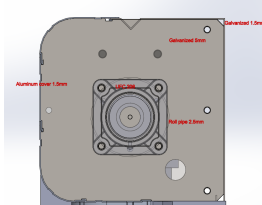

Door Leaf

PVC Sheet

Color



RAL 2002: Vermilion Orange
RAL 1007: Daffodil yellow
RAL 5005: Signal blue
RAL 7047: Tele grey
RAL 9003: Signal white
RAL 9004: Signal black

Material	Standard test method	high-strength polyester canvas fabric, coated with polyvinyl chloride
Weight(GMS)		1100(2000)
Surface treatment	EN ISO 2286-2	Double side PVC treatment
Thickness(mm)		0.8(1.5)
Tensile Strength(N/5cm)	DIN 53354	4200(5300)

Tearing Strength(N/5cm)	DIN 53363	450(820)
Peeling strength(N/5cm)	DIN 53357	120(150)
Color Fastness	EN ISO 105 B02	7~8
Fire retardant	DIN4102/GB8624	B2 (B1)
Temperature range(°C)	DIN EN 1876-1	-30~+70
Features: UV Treatment(No discolor), Waterproof, Anti-bacteria, Cold Resistance		

PVC Clear

Color
Material
Thickness(mm)

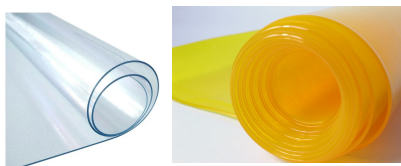

Clear/ Clear Yellow
high-strength polyester canvas fabric,
coated with polyvinyl chloride
1.5mm

PVC Mesh

Color
Material
Hole Size

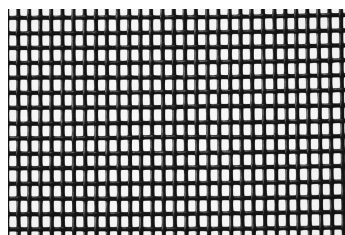

Black
high-strength polyester canvas fabric,
coated with polyvinyl chloride
1*2mm/3*6mm Two size

BOTTOM BAR

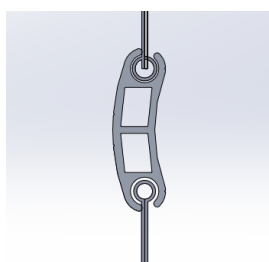

Aluminum alloy 6063 T5 1.5m~ 6mm

BRACER

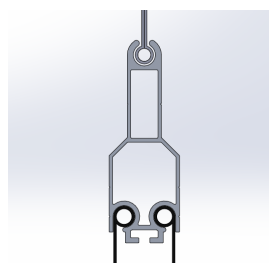

Aluminum alloy 6063 T5 1.5m*6mm

Safety sensor

Photo cell(Standard)

Response time
Detection distance
Material
IP grade
Detection object
Installation Height

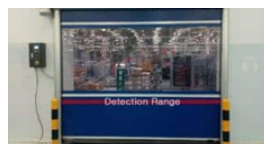

1~15ms
20m
Housing: Cu plated Cr Lens: PMMA
IP67
Min ∅ 18mm
500mm/1000mm

Light curtain sensor

Response time
Detection distance
Material
IP grade
Scanning height
Min detection object
Optical axis



2.5ms
6M
PC
IP67
1040mm
90mm
14point

Bottom airbag sensor

Response time
Material

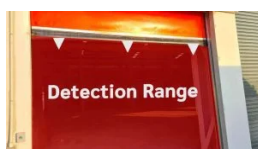

20ms
PC

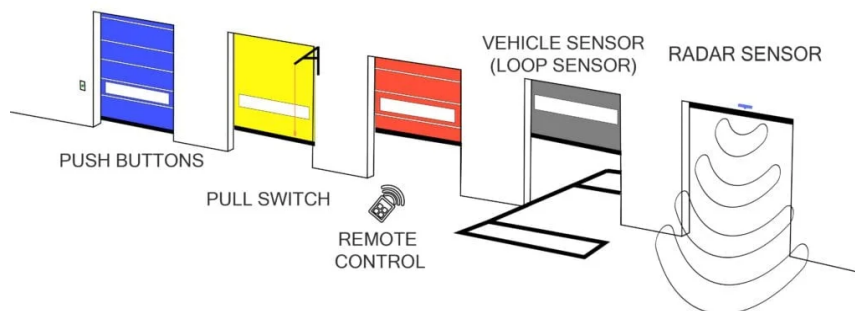

buttons(in-out)

Push buttons(in-out)(Standard)

Push button(standard)
Ip grade
Mechanical Life(cycle)



3 Point
IP 54

500000

Contactless button(in-out)

Signal
Ip grade
Mechanical Life(cycle)
Detection range
LED Indicator



1point
IP 65
100,000 tests in 3 months
2-10 cm
Blue LED: Standby / Green LED: Open

Pull switch

Signal
Ip grade
Mechanical Life(cycle)

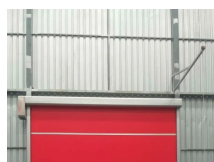

1point
IP 67

1500000

Sensors

EAGLE(BEA,Europe)

Techonology
Detection mode
Mounting Height
Ip grade
Material

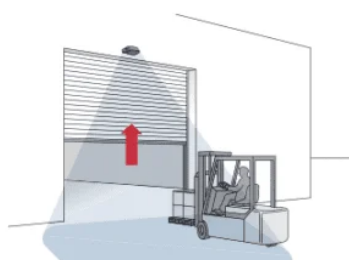

Microwave and microprocessor
Motion
1.5M~3.7M
IP 54
ABS

FALCON(BEA,Europe)

Techonology
Detection mode
Mounting Height
Ip grade
Material

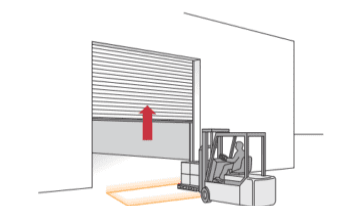

Microwave and microprocessor
Motion
3.5M~7M
IP 65
ABS

MATRIX(BEA,Europe)

Techonology
Detection mode
Mounting
Ip grade
Material



Inductive loop
presence or pulse
Under ground
IP 65
ABS

REMOTE(Sommer,German)

Radio control system
Radio commands
Range
Dimensions



SOMloq2
FM 922.5 MHz
Approx. 60 - 150 m (depending on the surroundings)
79 × 26 × 13 mm

Bolt&Nut

DIN 976-2 - M12x1.5 x 70
DIN 6923 - M12
ISO 4017 - M10 x 20
M3x25 screw

ISO/DIN Standard
Galvanized/Stainless